



Low Watt Medium Base EYE Multi-Metal™

FEATURES

- Compact ED17 or E17 bulb
- Full range of wattages
- Low watt types for open or enclosed fixture applications

APPLICATIONS

- General Lighting
- Manufacturing
- Schools/Universities
- Landscape Lighting
- Retail

PHYSICAL DATA AND CHARACTERISTICS

Line #	Watts (W)	Bulb	Base	Product Code	Product Description	ANSI Code/Ballast Ref.	Fix. Req.	Burn Pos.	Case Qty.	Initial Lumens	Mean Lumens	Average Life Hours	Color Temp. (K)	CRI
--------	-----------	------	------	--------------	---------------------	------------------------	-----------	-----------	-----------	----------------	-------------	--------------------	-----------------	-----

Low Watt Enclosed Fixture Series Metal Halide (Medium Base)

1	100	ED17 Clear	Med	54768	M100X/U/MED	M90/E	E	U	12	9000V 8100H	6800V 5900H	15000V 11250H	4000	65
2	100	ED17 Coated	Med	54915	MF100X/U/MED	M90/E	E	U	12	8500V 7700H	6200V 5500H	15000V 11250H	3700	70
3	175	ED17 Clear	Med	54866	M175X/U/MED	M57/E	E	U	12	14400V 12800H	10800V 9500H	10000V 7500H	4000	65
4	175	ED17 Coated	Med	55013	MF175X/U/MED	M57/E	E	U	12	13000V 11080H	10000V 8400H	10000V 7500H	3600	70

Low Watt Open/Enclosed Fixture Series Shrouded Arc Tube Metal Halide (Medium Base)

5	50	E17 Clear	Med	56748	MP50/U/3K	M110/O	O	U	20	3450	2000	15000V 10000H	3000	70
6	50	E17 Coated	Med	56944	MPF50/U/3K	M110/O	O	U	20	3200	1800	15000V 10000H	2900	70
7	70	E17 Clear	Med	56797	MP70/U/3K	M98/O	O	U	20	5200	3400	15000V 10000H	3000	75
8	70	E17 Coated	Med	56993	MPF70/U/3K	M98/O	O	U	20	4800	3200	15000V 10000H	2900	75
9	100	E17 Clear	Med	56650	MP100/U/3K	M90/O	O	U	20	8500	5600	15000V 10000H	3000	75
10	100	E17 Coated	Med	56846	MPF100/U/3K	M90/O	O	U	20	7900	5800	15000V 10000H	2900	75
11	150	E17 Clear	Med	56699	MP150/U/3K	M102/O	O	U	20	13000	10000	15000V 10000H	3000	75
12	150	E17 Coated	Med	56895	MPF150/U/3K	M102/O	O	U	20	12000	9000	15000V 10000H	2900	75

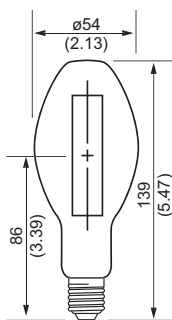

ED17, E17

Lamp Burn Position

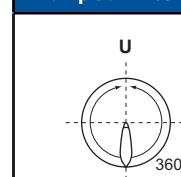

Notes:

1. Warning/Caution notices, see page 1-29
2. Operating Instructions, see page 1-29
3. All information subject to change without notice
4. V=Vertical, H=Horizontal Operation

All measurements shown as mm (in) unless otherwise noted.

Fixture Requirements:

- E = Enclosed Fixture Required
 S = Open fixture if the operating position is base up or down ±15°
 O = Open Fixture Permissible

See page I-3 for further information regarding fixture requirements.