

AL[™] AREA LIGHT INSTALLATION INSTRUCTIONS

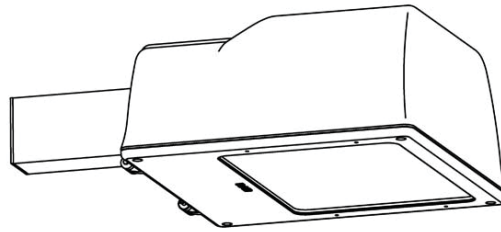

Thank you for buying RAB lighting fixtures. Our aim is to design the best quality products to get the job done right. We'd like to hear your comments. Call the Marketing Department at 888-RAB-1000, or email: marketing@rabweb.com

IMPORTANT

READ CAREFULLY BEFORE INSTALLING FIXTURE. RETAIN THESE INSTRUCTIONS FOR FUTURE REFERENCE.

RAB fixtures must be wired in accordance with the National Electrical Code and all applicable local codes. Proper grounding is required for safety. This product must be installed in accordance with the applicable installation code by a person familiar with the construction and operation of the product and the hazards involved.

WARNING: Make certain power is OFF before installing or maintaining fixture.

FIXED ARM

For full cutoff, mount arm oriented as shown below.

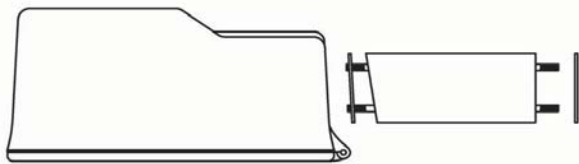

UP TILT FIXED ARM

For 6 degree up tilt, mount arm oriented as shown below.

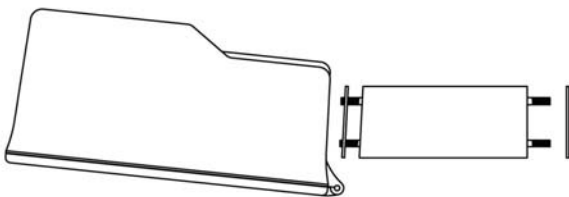

POLE DRILLING DETAIL

For mounting to a pole not drilled at RAB.

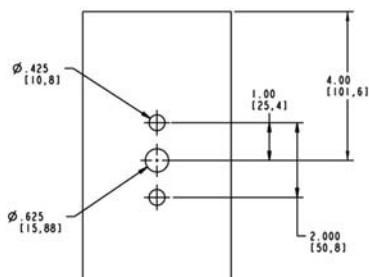

MOUNTING WITH SLIPFITTER

1. The slipfitter fits a 2 3/8" O.D. tenon. Place the slipfitter over the tenon and secure with the **(2) Set Screws** on the side of the slipfitter.
2. To adjust the angle of the fixture:
 - a. Remove **(2) Cover Plate Screws** and the **Round Cover Plate**.
 - b. Hold the top of fixture, loosen the **Locking Bolt** and swivel the fixture.
 - c. Tighten the **Locking Bolt** and re-attach the **Round Cover Plate**.

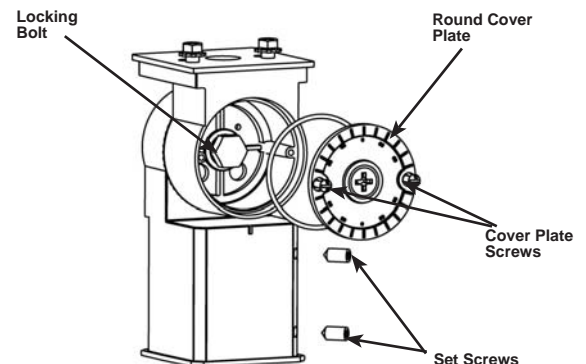

RAB fixture designs are protected under U.S. and International Intellectual Property laws. Patent pending.

Note: These instructions do not cover all details or variations in equipment nor do they provide for every possible situation during installation, operation or maintenance.

AL™ AREA LIGHT INSTALLATION INSTRUCTIONS

MOUNTING (1) AL FIXTURE DIRECTLY TO POLE

Fixed Arm mounting directly to 4" or larger square steel pole. Note **Arm Orientation** detail on first page.

1. Loosen (4) door screws, open fixture. Remove ballast cover.
2. Insert **Threaded Rods** into the pole and thread into the **Bolster Plate**.
3. Feed wires from fixture through **Gasket, Arm** and 2nd **Gasket** and into pole. Make connections and knot wires as a strain relief. Replace pole cap.
4. Line up extrusion slots with the **Threaded Rods** and slide **Arm** and fixture on **Threaded Rods**.
5. Place flat washer, lock washer and nut on the **Threaded Rods** inside the fixture and tighten securely.

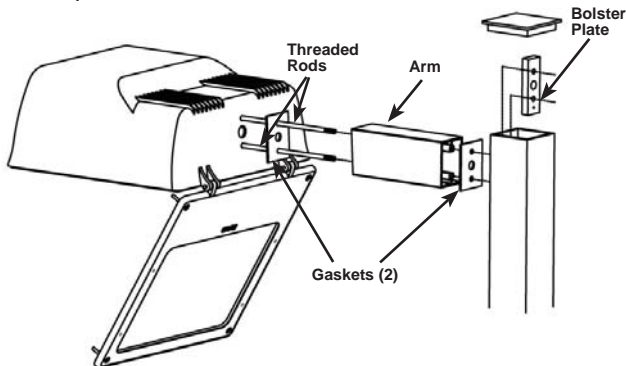

MOUNTING (2) AL FIXTURES AT 90° DIRECTLY TO POLE

Fixed Arm direct pole mounting of 2 fixtures at 90 degrees as shown below.

See steps 1-5 in "**MOUNTING (1) AL FIXTURE DIRECTLY TO POLE**" section. Follow for each fixture

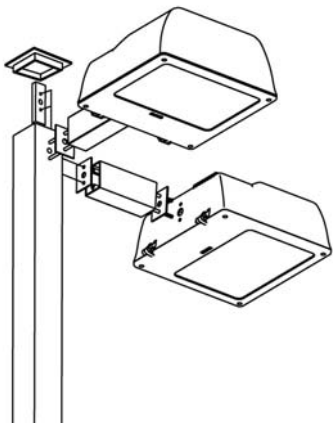

MOUNTING (2) AL FIXTURES AT 180° DIRECTLY TO POLE

Fixed Arm direct pole mounting of 2 fixtures at 180 degrees as shown below.

See steps 1-5 in "**MOUNTING (1) AL FIXTURE DIRECTLY TO POLE**" section. Follow for each fixture

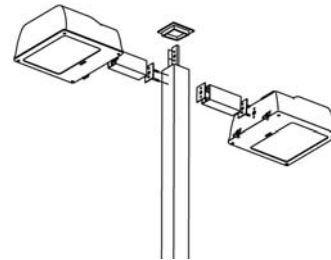

MOUNTING (3) AL FIXTURES DIRECTLY TO POLE

Fixed Arm direct pole mounting of 3 fixtures.

See steps 1-5 in "**MOUNTING (1) AL FIXTURE DIRECTLY TO POLE**" section. Follow for each fixture

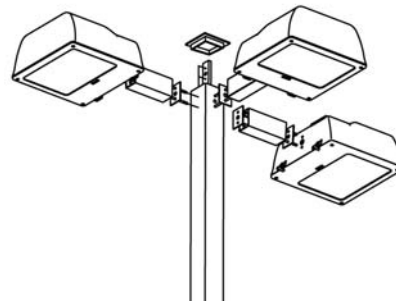

MOUNTING (4) AL FIXTURES DIRECTLY TO POLE

Fixed Arm direct pole mounting of 4 fixtures.

See steps 1-5 in "**MOUNTING (1) AL FIXTURE DIRECTLY TO POLE**" section. Follow for each fixture

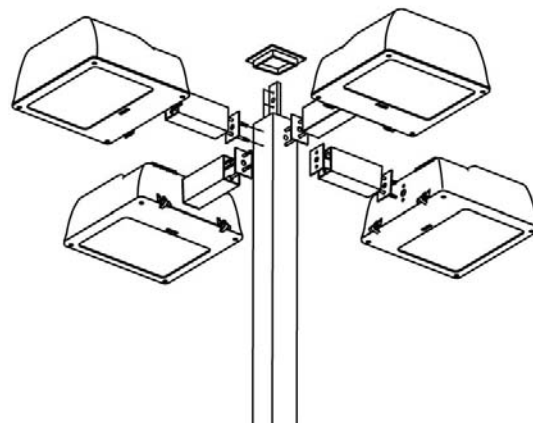

AL™ AREA LIGHT INSTALLATION INSTRUCTIONS

MOUNTING (1) AL FIXTURE TO BTA ADAPTOR

Fixed Arm mounting to RAB's pole top adaptor,

1. Loosen (4) door screws, open fixture. Remove ballast cover.
2. Insert **Threaded Rods** into the **Adaptor**.
3. Feed wires from fixture through **Gasket, Arm** and 2nd **Gasket** and into **Adaptor**. Make connections and push wires into the adaptor. Wires should be knotted as a strain relief.
4. Line up extrusion slots with the **Threaded Rods** and slide **Arm** and fixture on **Threaded Rods**.
5. Place flat washer, lock washer and nuts on each **Threaded Rod** inside the fixture. Tighten securely.
6. Place **Adaptor** over **2 3/8" Tenon** and tighten set screws on **Adaptor**.

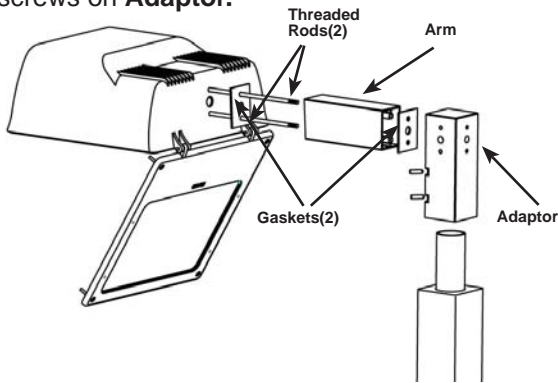

MOUNTING (2) AL FIXTURES AT 90° TO BTA ADAPTOR

Fixed Arm mounting to BTA90 for mounting 2 fixtures at 90 degrees as shown below.

See steps 1-6 in "**MOUNTING (1) AL FIXTURE TO BTA ADAPTOR**" section. Follow for each fixture.

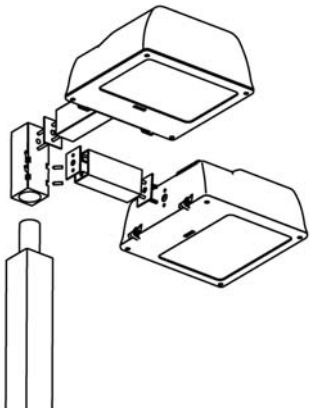

MOUNTING (2) AL FIXTURES AT 180° TO BTA ADAPTOR

Fixed Arm mounting to BTA180 for mounting 2 fixtures at 180 degrees as shown below.

See steps 1-6 in "**MOUNTING (1) AL FIXTURE TO BTA ADAPTOR**" section. Follow for each fixture.

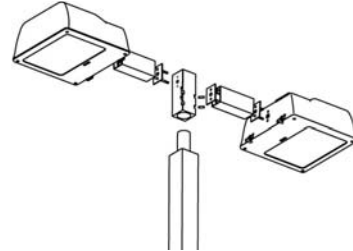

MOUNTING (3) AL FIXTURES TO BTA ADAPTOR

Fixed Arm mounting to BTA3 for mounting 3 fixtures as shown below.

See steps 1-6 in "**MOUNTING (1) AL FIXTURE TO BTA ADAPTOR**" section. Follow for each fixture.

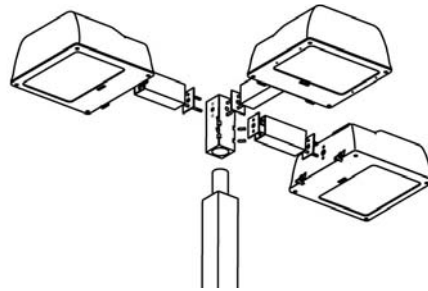

MOUNTING (4) AL FIXTURES TO BTA ADAPTOR

Fixed Arm mounting to BTA4 for mounting 4 fixtures as shown below.

See steps 1-6 in "**MOUNTING (1) AL FIXTURE TO BTA ADAPTOR**" section. Follow for each fixture.

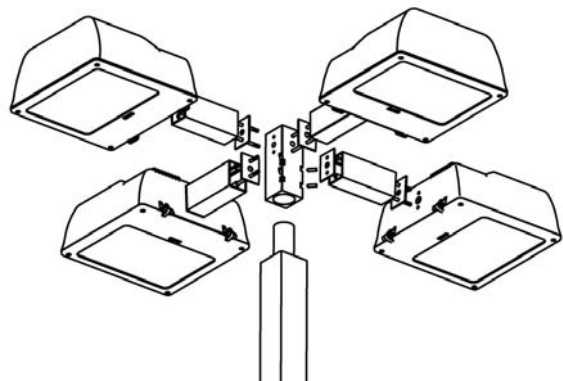

AL[™] AREA LIGHT INSTALLATION INSTRUCTIONS

LAMP INSTALLATION

CAUTION: Prior to installing, check that the lamp is the correct ANSI type and wattage. Observe lamp manufacturer's recommendations on lamp operation, ballast type and burning positions.

1. Disconnect power. Make sure fixture and lamp are cool enough to touch.
2. Loosen (4) screws from the door of the fixture. Screws will remain captive to door. Open and swing door down on hinges.
3. Fully screw the lamp into the socket.
4. Before closing door, make sure door gasket is properly seated all around the door.
5. Check that all mounting bolts are tight.
6. Close door. Tighten screws.

WIRING

All units are factory wired for 277V, except for units with a requested 120V Photocell ("PC"). If voltages other than 277V are required, remove ballast cover and rewire for the appropriate voltage.

1. Connect the black fixture lead to the (+) LINE supply lead.
2. Connect the white fixture lead to the (-) COMMON supply lead.
3. Connect the Ground wire from fixture to supply ground.
4. All unused leads must be capped and insulated.

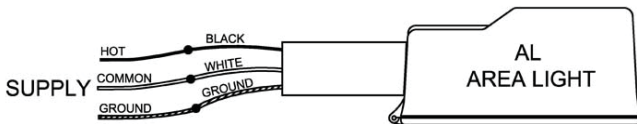

CLEANING & MAINTENANCE

CAUTION: Be sure fixture temperature is cool enough to touch. Do not clean or maintain while fixture is energized.

1. Clean glass lens with non-abrasive glass cleaning solution.
2. As lamps age, light output diminishes. Mass re-lamping at regular intervals ensures full light output at the highest efficiency.

REPLACEMENT LAMPS AND BALLASTS

Wattage	RAB Lamp Catalog#	ANSI Code	RAB Ballast Catalog#
High Pressure Sodium			
250	LHPS250	S50	BHPSH250QT
400	LHPS400	S51	BHPSH400QT
Metal Halide			
175	LMH175MOG	M57	BMHH175QT
200PS	LMH200PS	M136	BMHH200PSQ
250	LMH250	M58	BMHH250QT
250PS	LMH250PS	M153	BMHH250PSQ
320PS	LMH320PS	M154	BMHH320PSQ
350PS	LMH350PS	M131	BMHH350PSQ
400	LMH400Z	M59	BMHH400QT
400PS	LMH400PS	M155	BMHH400PSQ

480V Ballasts are available, consult factory.

TROUBLESHOOTING

1. Is the proper lamp installed? Check the wattage and ANSI code on the fixture label against markings on the lamp. Refer to Replacement Lamp table above for verification.
2. Make sure the lamp is not defective. Try a lamp known to be in operating condition.
3. Check that the line voltage at fixture is correct. Refer to wiring directions.
4. Is there voltage at the lamp socket? If there is no voltage, check all connections.
5. Is the fixture grounded properly?
6. Is the photocell functioning properly (if used)?

ACCESSORIES AND REPLACEMENT PARTS

Chrome Wire Guard:	GDMEG
House Side Shield:	MEGH9
Bolster Plate:	ALBP
Pole Top Tenon Adaptors:	BTA4