



# RT Series Time Switches



PROJECT
LOCATION/TYPE

## Product Overview

### Description

Watt Stopper/Legrand's digital time switches replace standard single-pole wall switches for energy savings throughout the home. The RT-50 and RT-100 switches turn controlled lights or fans OFF when the selected time expires.

### Operation: RT-100

Turning lights on with the RT-100 is accomplished by pressing the ON/OFF button, which activates the time function programmed by the installer. If a user wants the lights to remain on for a different time interval, they simply press and hold the ON/OFF button until the display shows the desired time. When the button is released, the lights will remain ON for the newly selected time interval. To turn lights off immediately, simply press the ON/OFF button. At any time, a user may press and hold the ON/OFF button for one second to restart the time switch, which will default to the interval programmed by the installer.

### Operation: RT-50

Turning lights on with the RT-50 is accomplished by pressing the desired time selection button, or the ON/OFF button. The lights will remain on for the duration of the time out setting that was last used and turns on the indicator light for that active time interval. Lights can be turned OFF before the time out setting expires by pressing the ON/OFF button. To change the time out setting, press the desired time selection button and the RT-50 will reset to that countdown interval.

### Applications

Digital time switches are an ideal lighting control choice for areas in homes where a wall switch vacancy or occupancy sensor may be inappropriate. The RT-50 seven-button preset time switch is suitable for small lights inside closets or bathroom exhaust fans. The RT-100 programmable countdown time switch is well suited for applications such as pantry, garage, outdoor lighting and spa where users will benefit from real time feedback of remaining countdown time as well as audible and visible warnings of impending shutoff.

## Features

### RT-100:

- Programmable Countdown Time Switch
- Adjustable time delay from 5-55 minutes (five-minute increments) to 1-12 hours (15-minute increments)
- Audible beep and visible light flash warnings before automatic-OFF
- Lighted switch for visibility in darkened rooms
- Choice of three decorator colors

### RT-50:

- Seven-button preset time switch
- Adjustable time delay: 1, 5, 10, 20, 30, 60 minutes
- Lighted switch for visibility in darkened rooms
- Choice of three decorator colors



## Specifications

- 120 VAC, 60 Hz
- Load requirements: 0-600W incandescent, fluorescent, compact fluorescent (CFL), magnetic low voltage (MLV), electronic low voltage (ELV), and 1/6 hp
- Neutral required
- Adjustable time delay: 1, 5, 10, 20, 30, 60 minutes (RT-50)
- Adjustable time delay from 5-55 minutes. (5 minutes. increments) to 1-12 hours. (15minutes. increments)
- 2.63" x 1.69" x 1.88" (67.8mm x 42.9mm x 47.8mm) L x W x D
- UL and CUL listed; five-year warranty

## Installation & Wiring

### Wiring for RT-100

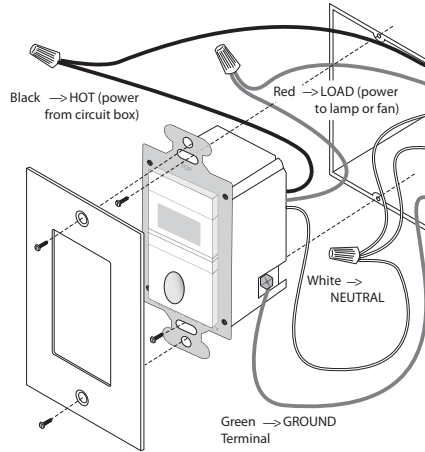

### Wiring for RT-50

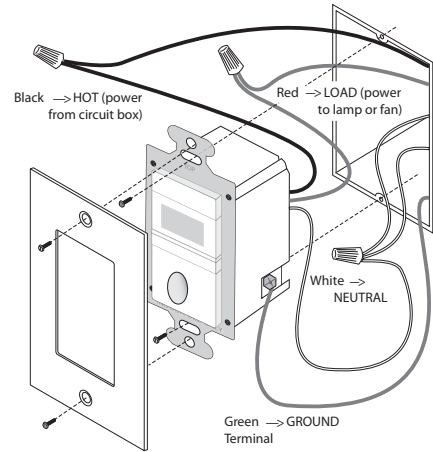

## Controls

### RT-100 Controls

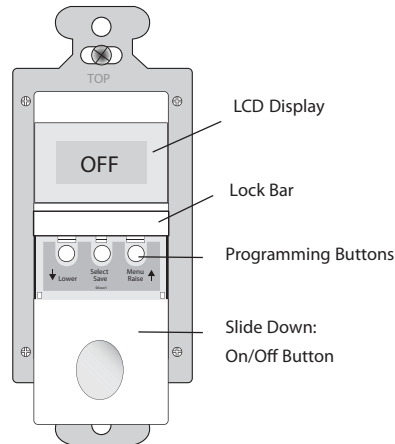

To access setup buttons gently pull the Lock Bar away from the switch face and slide the ON/OFF button down. (RT-100)

### RT-50 Controls

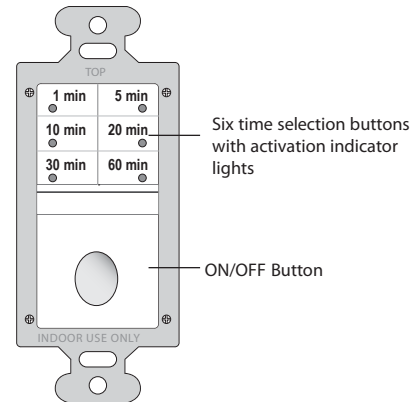

## Ordering Information

Catalog No.	Color	Special Feature	Voltage	Load Requirement
<input type="checkbox"/> RT-100-W	White	Programmable count down time switch	120 VAC; 60 Hz	0-600W incandescent, fluorescent, CFL, MLV, ELV, 1/6hp
<input type="checkbox"/> RT-100-I	Ivory			
<input type="checkbox"/> RT-100-LA	Lt. Almond			
<input type="checkbox"/> RT-100-B	Black			
<input type="checkbox"/> RT-50-W	White	Seven-button preset time switch	120 VAC; 60 Hz	0-600W incandescent, fluorescent, CFL, MLV, ELV, 1/6hp
<input type="checkbox"/> RT-50-I	Ivory			
<input type="checkbox"/> RT-50-LA	Lt. Almond			
<input type="checkbox"/> RT-50-B	Black			

One ASP-211 single-gang cover plate included. Order ASP-422 for blank cover plate for double-gang box, ASP-432 for cover plate for double-gang box with switch option (specify color).