

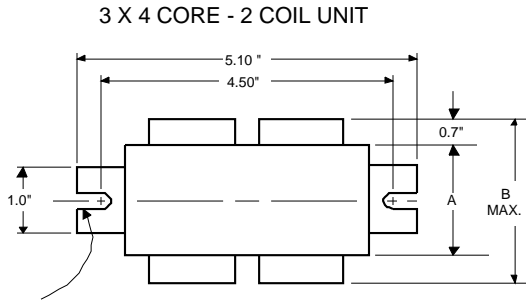

**Metal
Halide
Lamp Ballast**

**Catalog Number 71A5390
For 100W M90/M140
60 Hz HX-HPF
Status: Active**

DIMENSIONS AND DATA



0.25" WIDE
2 SLOTS

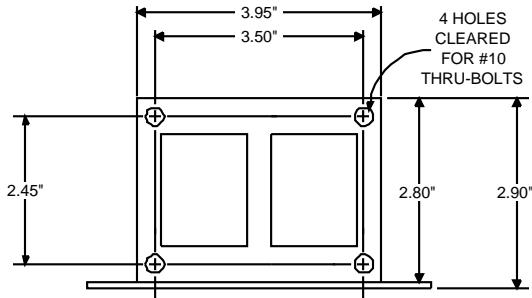

INPUT VOLTS	120	208	240	277
CIRCUIT TYPE	HX-HPF			
POWER FACTOR (min)	90%			
REGULATION				
Line Volts	±5%			
Lamp Watts	±12%			
LINE CURRENT (Amps)				
Operating.....	1.15	0.66	0.58	0.50
Open Circuit.....	2.30	1.40	1.15	1.00
Starting.....	1.20	0.80	0.65	0.60
UL TEMPERATURE RATINGS				
Insulation Class	H(180°C)			
Coil Temperature Code	1029			
MIN. AMBIENT STARTING TEMP.	-20°F or -30°C			
NOM. OPEN CIRCUIT VOLTAGE	265			
INPUT VOLTAGE AT LAMP DROPOUT.....	90	156	180	208
INPUT WATTS	129			
RECOMMENDED FUSE (Amps).....	6	4	3	3
CORE and COIL				
Dimension (A)	1.50			
Dimension (B)	2.80			
Weight (lbs.)	5.5			
Lead Lengths	12"			
CAPACITOR REQUIREMENT				
Microfarads	12.0			
Volts (min.)	280			
Fault Current Withstand (amps)				
60 Hz TEST PROCEDURES (Refer to Advance Test Procedure for HID Ballasts - Form 1270)				
High Potential Test (Volts)				
1 minute	2000			
2 seconds	2500			
Open Circuit Voltage Test (Volts)	240-300			
Short-Circuit Current Test (Amps)				
Secondary Current	1.35-1.70			
Input Current.....	1.00	0.60	0.50	0.40
	1.50	0.90	0.75	0.65

Capacitor: 7C120M30RA



Capacitance: 12
Dia/Oval Dim: 1.58
Height: 2.68
Temp Rating: 105°C

Ignitor: LI533-H4



Ballast to Lamp Distance
(BTL) = 20 feet
Temp Rating: 105°C



Wiring Diagram:

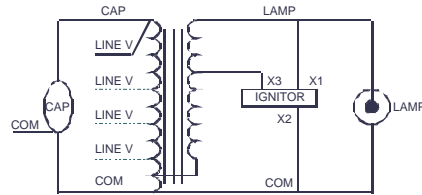

Fig. K3

Typical Ordering Information

(please call Advance for suffix availability)

Order Suffix	Description
500D.	Ballast With Ignitor and Dry Film Capacitor
510D.	Ballast w/Welded Bracket, Ignitor, & Dry Film Capacitor
600.	Ballast and Ignitor, No Capacitor
610.	Ballast with Welded Bracket and Ignitor, No Capacitor

Data is based upon tests performed by Advance Transformer in a controlled environment and representative of relative performance. Actual performance can vary depending on operating conditions. Specifications are subject to change without notice.

ADVANCE

O'HARE INTERNATIONAL CENTER · 10275 WEST HIGGINS ROAD · ROSEMONT, IL 60018
Customer Support/Technical Service: Phone: 800-372-3331 · Fax: 630-307-3071
Corporate Offices: Phone: 800-322-2086

10/10/07