



**EYE LIGHTING INTERNATIONAL
OF NORTH AMERICA, INC.**
A SUBSIDIARY OF IWASAKI ELECTRIC CO., LTD.

Home About Us Products How to buy Trade Shows Trade Associations Industry Links Lighting FAQs Lighting Library

MR16 - without Cover Glass

EYE Dichro-Cool®

Features

- Long Life; 5000 hrs for 35W, 50W and 65W / 4000 hrs for 20W and 75W
- Long lasting Dichroic coating
- Consistent light color and brightness

Applications

- Display case
- Museums
- Restaurants
- Retail stores
- Lounges
- Offices
- Home

Watts	Volts	Base	Product	Product	Product	Case	Ctr. Beam	Average	Color	Filament	Beam Spread
(W)	(V)		Code	Description	Comparison Guide	Qty.	Intensity (cd)	Life	Temp (K)		Data
20	12	GU5.3	71838	JR1201	20MR16/12°ESX	12	4300	4000	2950	C-6	1
	12	GU5.3	71887	JR1202	20MR16/23°BBF	12	950	4000	2950	C-6	2
	12	GU5.3	71936	JR1203	20MR16/40°BAB	12	525	4000	2950	C-6	3
35	12	GU5.3	72426	JR1301	35MR16/12°FRB	12	8000	5000	3050	C-6	4
	12	GU5.3	72475	JR1302	35MR16/23°FRA	12	2500	5000	3050	C-6	5
	12	GU5.3	72524	JR1303	35MR16/40°FMW	12	1200	5000	3050	C-6	6
42	12	GU5.3	72965	JR1401	42MR16/12°EYS	12	8200	5000	3050	C-6	7
	12	GU5.3	73014	JR1402	42MR16/25°EYS	12	2850	5000	3050	C-6	8
	12	GU5.3	73063	JR1403	42MR16/40°EYP	12	1200	5000	3050	C-6	9
50	12	GU5.3	73112	JR1501	50MR16/13°EXT	12	10500	5000	3050	C-6	10
	12	GU5.3	73161	JR1502	50MR16/26°EXZ	12	3400	5000	3050	C-6	11
	12	GU5.3	73210	JR1503	50MR16/32°ENL	12	2450	5000	3050	C-6	12
	12	GU5.3	73259	JR1504	50MR16/40°EXN	12	1750	5000	3050	C-6	13
	12	GU5.3	73357	JR1516	50MR16/60°FNV	12	750	5000	3050	C-6	14
	13.8	GU5.3	73308	JR1505	50MR16/12°EPZ	12	9000	5000	3050	C-6	15
75	12	GU5.3	74680	JR2701	75MR16/13°EYF	12	13500	4000	3050	C-6	16
	12	GU5.3	74729	JR2702	75MR16/26°EYJ	12	4600	4000	3050	C-6	17
	12	GU5.3	74778	JR2703	75MR16/44°EYC	12	2450	4000	3050	C-6	18

Burning Position: Universal

Lamp Drawings unit: mm (inches)

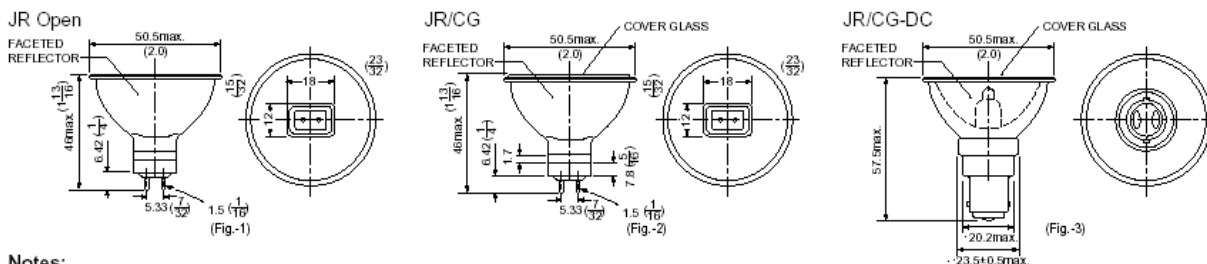

Notes:

--top--