

Type \_\_\_\_\_

Project \_\_\_\_\_

Catalog No. \_\_\_\_\_

Lamp/Wattage \_\_\_\_\_

**NTH-109**

**Flatback Universal Lamp Holder**

Lamp: 50W R20/PAR20 / 75W BR30/PAR30  
250W PAR38 / 300W BR40

**PRODUCT DESCRIPTION**

Line voltage universal lamp holder with adjustable angle. Smooth, cylindrical design with softened edges on rear of housing for aesthetic, modern appearance. Lateral and vertical swivel enable user to aim the light source to any desired location. Adjustment knob on housing side allows user to extend or retract the neck of the lamp source.

**FEATURES**

- Deep drawn steel housing for high strength and rigidity
- Heat resistant Teflon coated wire lead
- Adjustable angle for custom aiming
- High-strength stainless steel electrical contacts
- One or two circuit track capable

**CONSTRUCTION**

**Housing**

0.025" Deep drawn steel construction with softened edges for clean, low profile appearance.

**Swivel Arm**

0.080" Rigid steel arm connects fixture housing to electrical contact head. Plastic angle tightening knob maintains clean, decorative appearance of the fixture.

**Socket**

Porcelain jacketed aluminum screw thread medium-base socket.

**Wiring**

Teflon coated wire lead connects socket and housing to electrical contact head. Teflon coating is durable and resists heat degradation from lamp and housing radiation.

**Lamp**

- 50W R20/PAR20 Maximum (not included)
- 75W BR30/PAR30 Maximum (not included)
- 250W PAR38 Maximum (not included)
- 300W BR40 Maximum (not included)

**Contact Head Assembly**

"H" Style (standard): Three 0.030 stainless steel contacts mounted in premium plastic housing.

"J" Style: Two contacts and ground contact mounted in premium plastic housing with on/off switch.

"L" Style: Two contacts and ground contact mounted in premium plastic housing.

**Finishes**

Black, Natural Metal, or White heat rated baked enamel paint. Custom painting or anodizing for special applications are also available. Custom finishes will require lead times that vary depending on vendor schedule. Please consult factor for quotation, and provide either a Dunn Edwards number or color chip for exact matching.

**One/Two Circuit Conversion**

Positive contact (opposite neutral and ground contacts) is preset to "down" position at the factory, but may be raised to the high position to install onto the second circuit of Nora Lighting's NT-2300 series two-circuit track.

**Compatibility**

H-Style is compatible with Halo or any other brands configured to Halo 3 (single circuit) or Halo 4 (2 circuit) track system design.

J-Style is compatible with "J" Style track.

L-Style is compatible with "L" Style track.

*Note: fixtures may not be compatible with non-Nora monopoint adapters.*

**Listing**

UL Listed as track lighting fitting



**ITEM NUMBERS**

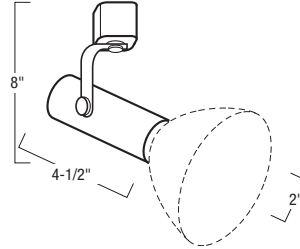

**NTH-109 Dimensions:**  
Diameter: 2"  
Length: 4-1/2"  
Max. Ext.: 8"

*Note: All dimensions are given without lamp installed and vary depending on lamp.*

- NTH-109B: Black Flatback Universal Lamp Holder, H-Style
- NTH-109B/J: Black Flatback Universal Lamp Holder, J-Style
- NTH-109B/L: Black Flatback Universal Lamp Holder, L-Style
- NTH-109N: Natural Metal Flatback Universal Lamp Holder, H-Style
- NTH-109N/J: Natural Metal Flatback Universal Lamp Holder, J-Style
- NTH-109N/L: Natural Metal Flatback Universal Lamp Holder, L-Style
- NTH-109W: White Flatback Universal Lamp Holder, H-Style
- NTH-109W/J: White Flatback Universal Lamp Holder, J-Style
- NTH-109W/L: White Flatback Universal Lamp Holder, L-Style