

Plusrite®

CATALOG NUMBER: BAPS1000-CWA/V4

1000W M141

**Pulse Start Metal Halide Lamp Ballast
60 Hz CWA**

4X6 CORE - HX, CWA CWI UNITS

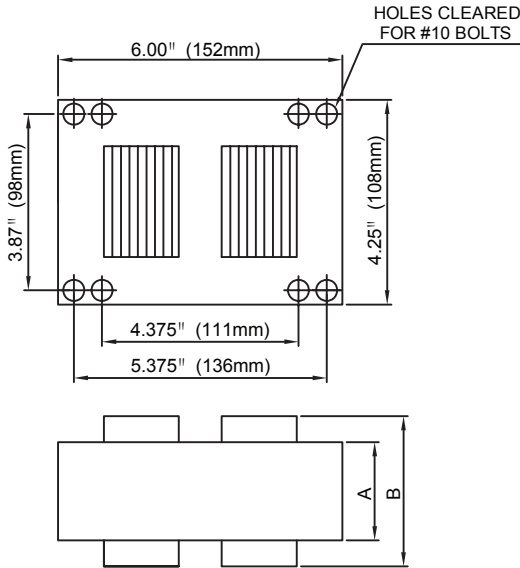

Input Volts		120	208	240	277
Circuit Type	CWA				
REGULATION					
Line Volts	±10%				
Lamp Watts	±10%				
LINE CURRENT(Amps)					
Operating		9.00	5.20	4.50	3.90
Open Circuit		6.00	3.50	3.00	2.60
Starting		6.00	3.50	3.00	2.60
RECOMMENDED FUSE (Amps)					
		25	15	12	10
TEMPERATURE RATINGS					
Insulation Class	180 (H)				
Coil Temperature Code		D	A	B	B
Benchtop Coil Rise		88.2	73.5	78.4	78.2
Power Factor (Min)	90%				
Input Watts	1082 W				
Efficiency	92%				
NOM. OPEN CIRCUIT VOLTAGE					
	420				
INPUT VOLTAGE AT LAMP DROPOUT					
		70	125	140	160
MIN AMBIENT STARTING TEMP					
	-20°F/-30°C				

Capacitor:

Microfarads: 24.0 uf
Volts (Max): 480 V
Case Temp(Max): 100°C
D: 1.97 in
L: 3.94 in
A: 0.79 in

Ignitor:

Case Temp (Max): 105 °C
BTL Distance (Max): 15 ft

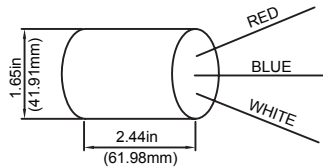
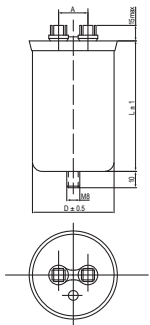

60 HZ TEST PROCEDURES

High Potential Test (Volts)					
1 Minute		1,850 V			
1 Second		2,200 V			
Open Circuit Voltage Test (V)					
		380 - 460			
Short Circuit Current Test (A)					
Secondary Current	Min	4.75			
	Max	5.85			
Input Current	Min	4.80	2.80	2.40	2.10
	Max	7.20	4.20	3.60	3.15

CORE and COIL Specifications

Dimension A (in)	2.80
Dimension B (in)	4.80
Weight (lbs)	21.0
Lead Lengths (in)	12

CAPACITOR REQUIREMENT

Microfarads	24.0uf
Volts (Min)	480 V

Wiring Diagram:

cRU[®] RoHS

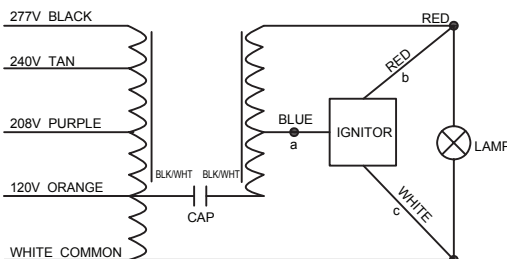

ORDERING INFORMATION

The ballast is prewired comes with a kit including capacitor, ignitor and bracket.

Data is based upon tests performed by Plusrite in a controlled environment and is representative of relative performance. Actual performance can vary depending on operating conditions. Specifications are subject to change without notice.

Coil material: Cu/Al