



CATALOG NUMBER: BALU1000-CWA/V5

1000W S52

High Pressure Sodium Lamp Ballast

60 Hz CWA

4X6 CORE - HX, CWA CWI UNITS

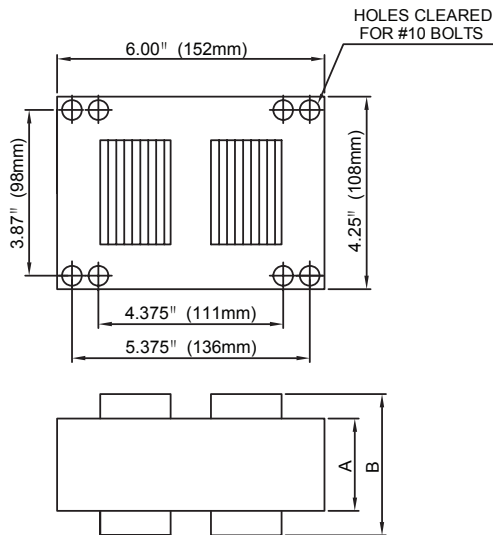

| | | | | | | |
|--------------------------------------|-------------|------|------|------|------|------|
| Input Volts | | 120 | 208 | 240 | 277 | 480 |
| Circuit Type | CWA | | | | | |
| REGULATION | | | | | | |
| Line Volts | ±10% | | | | | |
| Lamp Watts | ±14% | | | | | |
| LINE CURRENT(Amps) | | | | | | |
| Operating | | 9.50 | 5.50 | 4.75 | 4.20 | 2.31 |
| Open Circuit | | 4.80 | 2.75 | 2.40 | 2.05 | 0.96 |
| Starting | | 7.20 | 4.15 | 3.60 | 3.10 | 1.90 |
| RECOMMENDED FUSE (Amps) | | | | | | |
| | | 25 | 15 | 12 | 10 | 6 |
| TEMPERATURE RATINGS | | | | | | |
| Insulation Class | H | | | | | |
| Coil Temperature Code | | C | B | C | C | C |
| Benchtop Coil Rise | | 83.8 | 77.8 | 81.8 | 80.5 | 80.5 |
| Power Factor (Min) | 90% | | | | | |
| Input Watts | 1100 W | | | | | |
| Efficiency | | | | | | |
| CURRENT CREST FACTOR | | | | | | |
| | 1.65 | | | | | |
| NOM. OPEN CIRCUIT VOLTAGE | | | | | | |
| | 425 | | | | | |
| INPUT VOLTAGE AT LAMP DROPOUT | | | | | | |
| | | 95 | 170 | 190 | 220 | 360 |
| MIN AMBIENT STARTING TEMP | | | | | | |
| | -40°F/-40°C | | | | | |

Capacitor:

Microfarads: 26.0 uf
 Volts (Max): 540 V
 Case Temp(Max): 100°C
 D: 1.97 in
 L: 3.94 in
 A: 0.79 in

Ignitor:

Case Temp (Max): 105°C
 BTL Distance (Max): 15 ft

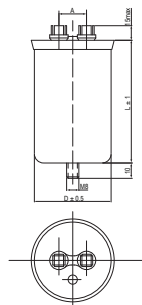

Oil-Filled Capacitor

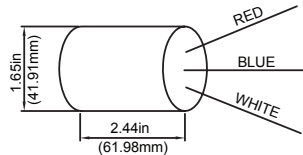

| | | | | | | |
|---------------------------------------|-----|-----------|------|------|------|------|
| 60 HZ TEST PROCEDURES | | | | | | |
| High Potential Test (Volts) | | | | | | |
| 1 Minute | | 2,000 V | | | | |
| 1 Second | | 2,400 V | | | | |
| Open Circuit Voltage Test (V) | | 380 - 470 | | | | |
| Short Circuit Current Test (A) | | | | | | |
| Secondary Current | Min | 6.20 | | | | |
| | Max | 7.60 | | | | |
| Input Current | Min | 5.20 | 3.15 | 2.60 | 2.35 | 1.46 |
| | Max | 8.20 | 4.80 | 4.10 | 3.55 | 2.19 |

| | | | | | | |
|-------------------------------------|--|------|--|--|--|--|
| CORE and COIL Specifications | | | | | | |
| Dimension A (in) | | 4.33 | | | | |
| Dimension B (in) | | 5.91 | | | | |
| Weight (lbs) | | 27.0 | | | | |
| Lead Lengths (in) | | 12 | | | | |

| | | | | | | |
|------------------------------|--|---------|--|--|--|--|
| CAPACITOR REQUIREMENT | | | | | | |
| Microfarads | | 26.0 uf | | | | |
| Volts (Min) | | 525 V | | | | |

Wiring Diagram:

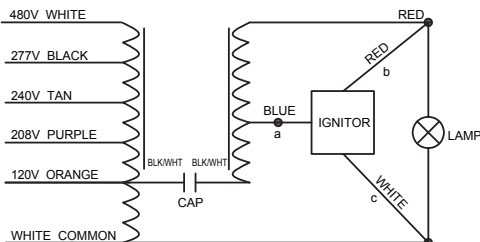

ORDERING INFORMATION

The ballast is prewired comes with a kit including capacitor, ignitor and bracket.

Data is based upon tests performed by Plusrite in a controlled environment and is representative of relative performance. Actual performance can vary depending on operating conditions. Specifications are subject to change without notice.

Coil material: Cu/Al