

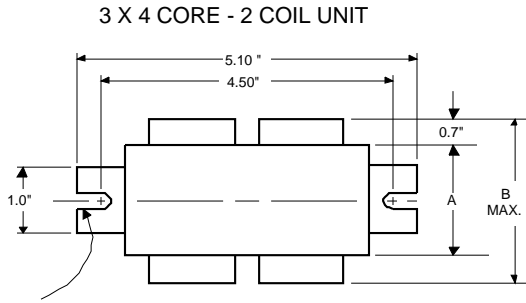

**Metal
Halide
Lamp Ballast**

**Catalog Number 71A5292
For 70W M98/M143
60 Hz HX-HPF
Status: Active**

DIMENSIONS AND DATA



0.25" WIDE
2 SLOTS

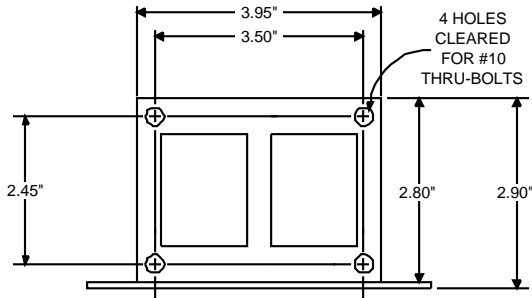

INPUT VOLTS	120	208	240	277
CIRCUIT TYPE	HX-HPF			
POWER FACTOR (min)	90%			
REGULATION				
Line Volts	±5%			
Lamp Watts	±7%			
LINE CURRENT (Amps)				
Operating.....	0.80	0.46	0.40	0.35
Open Circuit.....	1.90	1.00	0.90	0.80
Starting.....	0.55	0.30	0.25	0.25
UL TEMPERATURE RATINGS				
Insulation Class	H(180°C)			
Coil Temperature Code	1029			
MIN. AMBIENT STARTING TEMP.	-20°F or -30°C			
NOM. OPEN CIRCUIT VOLTAGE	255			
INPUT VOLTAGE AT LAMP DROPOUT.....	90	156	180	208
INPUT WATTS	88			
RECOMMENDED FUSE (Amps).....	4	3	2	2
CORE and COIL				
Dimension (A)	1.45			
Dimension (B)	2.75			
Weight (lbs.)	5			
Lead Lengths	12"			
CAPACITOR REQUIREMENT				
Microfarads	8.0			
Volts (min.)	280			
Fault Current Withstand (amps)				
60 Hz TEST PROCEDURES (Refer to Advance Test Procedure for HID Ballasts - Form 1270)				
High Potential Test (Volts)				
1 minute	2000			
2 seconds	2500			
Open Circuit Voltage Test (Volts)	230-280			
Short-Circuit Current Test (Amps)				
Secondary Current	0.95-1.25			
Input Current.....	0.55	0.35	0.30	0.25
	0.80	0.50	0.50	0.45

Capacitor: 7C080L33-R



Capacitance: 8
Dia/Oval Dim: 1.25
Height: 2.9
Temp Rating: 105°C

Ignitor: LI533-H4



Ballast to Lamp Distance
(BTL) = 15 feet
Temp Rating: 105°C



Wiring Diagram:

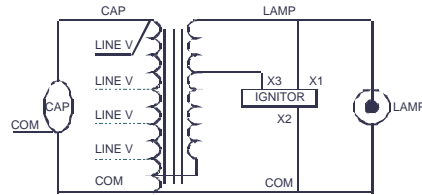

Fig. K3

Typical Ordering Information

(please call Advance for suffix availability)

Order Suffix	Description
500D.	Ballast With Ignitor and Dry Film Capacitor
510D.	Ballast w/Welded Bracket, Ignitor, & Dry Film Capacitor
600.	Ballast and Ignitor, No Capacitor
610.	Ballast with Welded Bracket and Ignitor, No Capacitor

Data is based upon tests performed by Advance Transformer in a controlled environment and representative of relative performance. Actual performance can vary depending on operating conditions. Specifications are subject to change without notice.

ADVANCE

O'HARE INTERNATIONAL CENTER · 10275 WEST HIGGINS ROAD · ROSEMONT, IL 60018
Customer Support/Technical Service: Phone: 800-372-3331 · Fax: 630-307-3071
Corporate Offices: Phone: 800-322-2086

12/08/00