



HB116R OUTDOOR TIMER INSTRUCTIONS

Thank you for purchasing the HB116R Outdoor Timer with Stake and Receptacles. Please read the instructions below, before using this product:

Features

- Weather resistant cover with latch to secure up to six extension cords
- Six grounded outlets controlled by an easy-to-set timer
- Timer features two ON and OFF settings per day
- Unit can be wall mounted, or used with easy-to-install ground stake
- Added safety features include grounded cord and 15 Amp circuit breaker
- Manual override switch.

Timer Instructions (See Fig. 1)

1. Insert ON (Green) trippers and OFF (Red) trippers into dial at desired ON and OFF times.
2. Turn dial clockwise (→) one or more complete revolutions until the arrow head is aligned with the current time of day. Please note that AM times are in the white section of the dial, and PM times are in the black section of the dial.
3. Turn lamp or appliance ON.
4. Plug lamp or appliance cords into timer receptacles. Close and latch timer cover to protect receptacles from moisture. Plug timer cord into GFCI protected wall outlet if located outdoors.

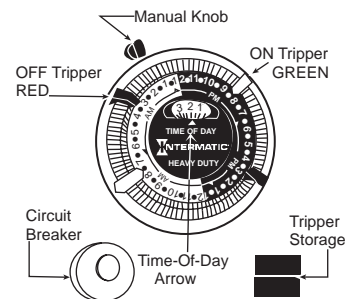

Figure 1

Manual Override: Timer may be turned ON or OFF manually, by turning the override knob counterclockwise (←). The timer will resume the next scheduled ON and OFF cycle automatically. See Figure 1.

Circuit Breaker: If unit does not function properly, the circuit breaker may have been activated. To reset, unplug the timer from power source. Check to make sure the combined load of the lamps or appliances does not exceed the rated capacity of the timer. If so, disconnect items until the electrical load is within the prescribed limits. Press the circuit breaker button to reset. Plug timer into outlet and test by turning the manual override knob counterclockwise. See Figure 1.

NOTE: Whatever timer setting(s) are chosen, the setting(s) will apply to all 6 receptacles.

Wall Mounting the Timer: If timer is mounted on a wall, it must be at least 3 feet above the ground.

Stake Mounting: Place tabs on stake over the retention holes on the back of the timer. Push up on stake until tabs lock in place. See Figure 2. The stake should be inserted in the ground up to the barrier on the stake. See Figure 3. **DO NOT DRIVE THE STAKE INTO THE GROUND.** In order to avoid potential hazard, the extension cord should be clipped into the stake as shown in Figure 4. This will keep the plugs off the ground.

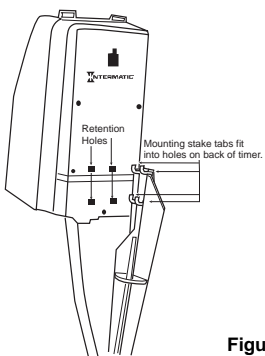

Figure 2

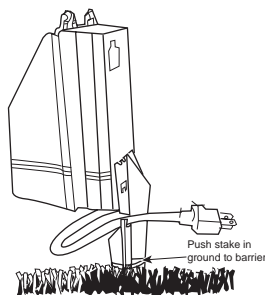

Figure 3

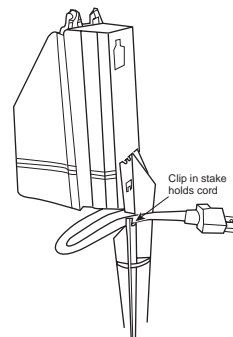

Figure 4

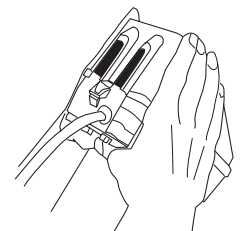

Figure 5

Latching the cover: Hold cover and rear of unit with **both** hands and press firmly until latch snaps into place. (Fig. 5)

NOTE:

Wall Receptacle Cover: In order to meet the 2002 National Electric Code you should use a receptacle cover that protects your outdoor receptacle when your timer is plugged in. Recommended for use are Intermatic Model WP1100C or for heavier cords sets, Models WP1110C or WP1150C.

Electrical Ratings

- 15 Amp Resistive (heater), 1800 Watts
- 15 Amp Tungsten (Incandescent), 1800 Watts
- 120 Volts AC, 60 Hz

For Your Safety

Do not modify, splice or repair this unit. Do not use in wet conditions. Store unit indoors when not in use. Fully insert plugs. For adult use only. Do not exceed electrical load ratings. Fully extend power cord before using. Not intended as a permanent source of power.

Limited One Year Warranty

If within (1) year from the date of purchase, this product fails due to a defect in workmanship, Intermatic Incorporated will repair or replace, at its sole option, free of charge. This warranty applies only to the original purchaser and is not transferable.

INTERMATIC INCORPORATED WILL NOT BE LIABLE FOR INCIDENTAL OR CONSEQUENTIAL DAMAGES. SOME STATES DO NOT ALLOW THE EXCLUSION OR LIMITATION OF INCIDENTAL OR CONSEQUENTIAL DAMAGES, SO THE ABOVE LIMITATION OR EXCLUSION MAY NOT APPLY TO YOU.

THIS WARRANTY IS IN LIEU OF ALL OTHER EXPRESS OR IMPLIED WARRANTIES. ALL IMPLIED WARRANTIES, INCLUDING THE WARRANTY OF MERCHANTABILITY AND WARRANTY OF FITNESS FOR A PARTICULAR PURPOSE, ARE HEREBY MODIFIED TO EXIST ONLY AS CONTAINED IN THIS LIMITED WARRANTY, AND SHALL BE OF THE SAME DURATION AS THE WARRANTY PERIOD STATED ABOVE. SOME STATES DO NOT ALLOW LIMITATIONS ON THE DURATION OF AN IMPLIED WARRANTY, SO THE ABOVE LIMITATION MAY NOT APPLY TO YOU.

This warranty does not apply to: (a) damage caused by accident, abuse in handling, dropping; (b) acts of God; (c) units which have subject to unauthorized repair, opened, taken apart or otherwise modified; (d) units not used in accordance with directions; (e) damages exceeding the cost of the product; (f) sealed lamps and/or lamp bulbs, LEDs and batteries; (g) the finish on any portion of the product, such as surface scratches and/or weathering, as this is considered normal wear and tear. Some states do not allow a limitation of damages so the foregoing limitation may not apply to you. This warranty gives you specific legal rights and you may also have other rights, which vary from state to state.

Warranty service is available by mailing postage prepaid to: Intermatic Incorporated/After Sales Service/7777 Winn Rd., Spring Grove, IL 60081-9698/815-675-7000 <http://www.intermatic.com> Please be sure to wrap the product securely to avoid shipping damage.

INTERMATIC INCORPORATED
SPRING GROVE, ILLINOIS 60081-9698