

1. General

Model	Rated voltage	Rated frequency	Rated current	Rated power	IP Class	Type of electricity protection
WL-3CM	AC 220-240V	50-60Hz	8A	1920W	IP20	I
WL-3CM	AC 100-120V	50-60Hz	8A	960W	IP20	I
WL-3CM	AC 24V	50-60Hz	8A	192W	IP20	III
WL-3CM	AC 12V	50-60Hz	8A	96W	IP20	III

Note: Please refer to the label for the details.

2. Operation instruction

1. Plug the power plug to power outlet and make sure both have the same rating.
2. Turn controller to ON position, ropelight will start working.
3. Turn the chase-mode button to choose a desired pattern, there are six choices. Operating effects are as follows:

3.1. Static illuminating;	3.4. Chasing;	3.7. AABB Flashing
3.2. Circle A Flashing;	3.5. Flashing;	3.8. Automatic cycle
3.3. Circle B Flashing;	3.6. Chasing Flash.	
4. Turn speed button to adjust speed. The speed changes from slow to fast when turning clockwise; otherwise the speed will slower.
5. Turn audio button to adjust the sound sensitivity. Dial clockwise to increase sensitivity, otherwise the sensitivity will decrease.
6. Control panel introduction.
 ON,OFF: power switch.
 SPEED: speed control switch.
 CHASE-MODE: chase-mode switch.
 INDICATOR: Demonstration LED .

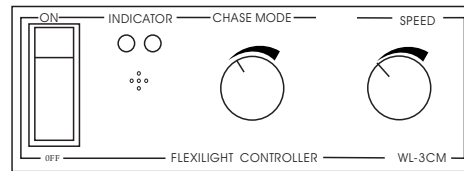

(1)

3. Warning

1. Rated voltage of power outlet must be the same as input voltage of the controller.
2. The loading current of the lighting can't exceed 8A.
3. Don't use in water or in the environment that burn or explode easily. It must be used in ventilative environment.
4. Do not use anything to cover the controller in order to dissipate heat when you use it.
5. For indoor use only.
6. Keep out of reach from children or use when adult is present.

4. Instructions to Use

I. Check the ropelight (Refer to diagram 2)

- a. Check the voltage of the ropelight to see if it matches with the voltage of the controller (connection is only possible under the same voltage).

- b. Measure the length of the ropelight, its length cannot exceed the maximum loading length. Cut the ropelight according to the Cutting Mark as indicated on the ropelight. Make sure that all split ends are cut at the given marking.
- c. Bend both ends of the ropelight to show 2~3mm of the wire. Use a pair of scissors to cut away the split ends. Make sure that all split ends are cut away neatly; or else it will cause a short circuit and possibly burn the controller.
- d. Cover the end of ropelight with an appropriate End Cap and seal with silicone adhesive and tie with a tie strap for insulation. The other end of the ropelight can be joined to a power cord.

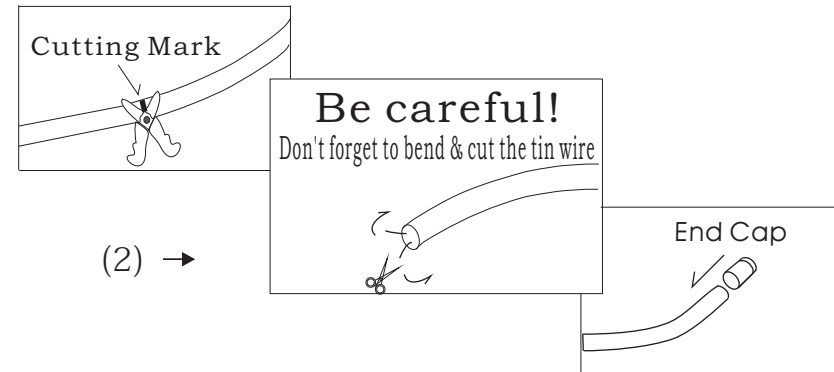

(2) →

II. Connecting to Power Source

There are five ways to connect the controller power output to the ropelight. Please check the accessories carefully and install in the right way.

Method 1: Spiral Connection: (Refer to diagram 3)

- a. Put the spiral nut (No.4) with thread onto one end of the ropelight.
- b. Insert the splice connector pin (No.3) into the inner wires of the ropelight vertically.
- c. After the insertion is done, tighten the spiral nut.
- d. Connect the splice connector crimp (No.2) with the wire connector, then tighten the spiral nut (No.1).

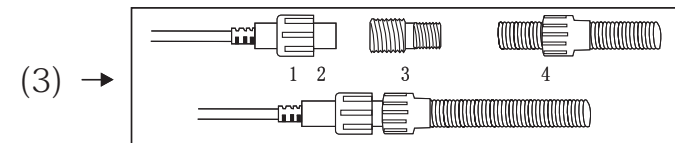

(3) →

(Caution: This way is only for indoor use.)

Method 2: Housing Clamp Connection:(Refer to diagram4)

- a. Insert the splice connector pin into the inner wires of the ropelight; then insert the splice connector crimp into the holes of the female power connector.
- b. Place the splice connector at the center compartment of the housing clamp female cover, apply glue thoroughly to 100% insulate splice connector, ropelight and power connector
- c. Cover the female portion by male portion of housing clamp and tighten all screws.

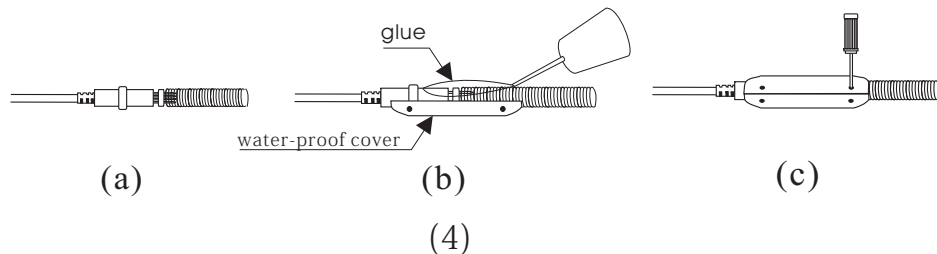

Method 3:PVC Power Supply Connector Connection:

Make sure that the ropelight which to be joined with the connector is not connected with any electricity & was cut nearly as instruction cutting rope light stated.

- a. Insert the male pin connector into centre of the tubes of the ropelight. The male pin & the ropelight must run straightly.

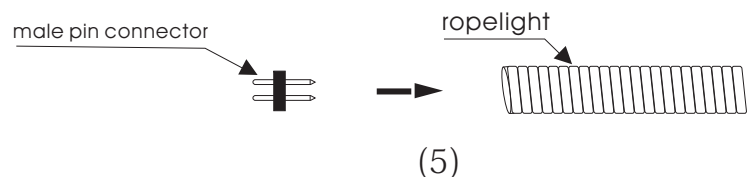

- b. Place the shrinkable tube over the ropelight.
- c. Apply glue (around 3cm long from the end of the ropelight) on the ropelight. Now push the ropelight into the power supply so that the connector pins completely disappear into the sockets. Leave the glue dry before continuing installation.

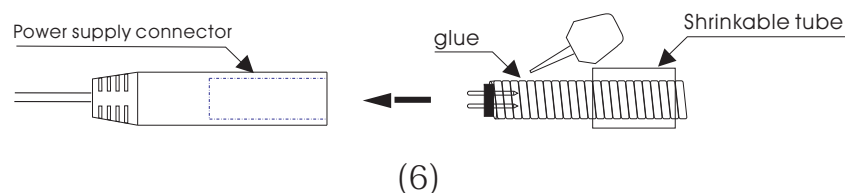

- d. Push half of the shrinkable tube over the power supply connector & half over the ropelight & heat it up.

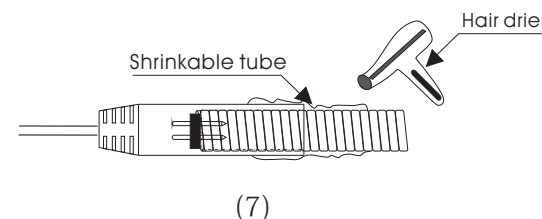

(Notice:) Connectors and joints can only withstand a limited amount of mechanical pressure.

Method 4:Injection Molding Connection:

As the controller and the ropelight have been connected by the plastic injection connector, the user may only plug the controller's power plug to the right power outlet and begin to use.

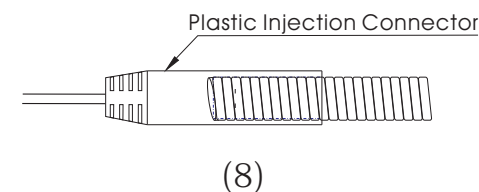

Method 5:Light String Connection:

Besides, this controller also has the control effect on these products like : flexi-curtain,pearlight,shellight ,icicle light ,rattan flexi-star which are produced in our factory .the connecting method for the light string and the output connector of the controller is very simple :you only need to connect the output female connector with the male connector on the light string.

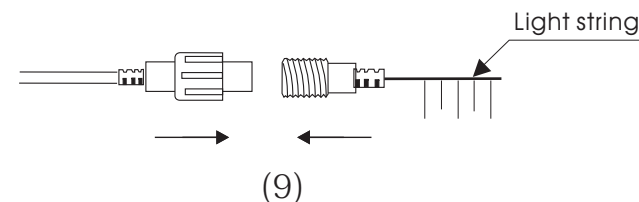

Our company has always put design and quality of our products in first priority. Should there be any changes, there will not be any notifications.