

Thank you for purchasing the Mr. Beams™ Motion Sensor Stair Light. We are committed to eliminating darkness by using the latest in light-emitting diodes (LED's). LED's are the most efficient and durable light sources available. We are certain that your Motion Sensor Stair Light will contribute to a safer environment and provide light where you need it at a very reasonable cost.

**ENCLOSED YOU WILL FIND:**

- Motion Sensor Stair Light
- Double-Sided Tape\*
- 2 Screws and 2 Anchors

**MB530 STAIR LIGHT FEATURES**

**Low-Glow** – Your Motion-Sensor Stair Light glows automatically when in darkness to show you its location.

**Motion Sensor Activated** – Once motion is detected, your Motion-Sensor Stair Light lights up brightly. Light shuts off automatically if no motion is detected after the set time and returns to Glow Mode.

**Light Sensor** – Motion-Sensor Stair Light goes on only in darkness to conserve battery life.

**Weatherproof** – Motion-Sensor Stair Light can be mounted outside or inside.

**WARNING**

- **If your light stays on constantly, it's time to change the batteries!**
- Please mount fixture securely with included screws, and use anchors if not securing to solid wood or other solid material.
- **Note that this is a strong adhesive tape and may cause damage to paint, wallpaper, or surface underneath if removed.**
- Your Stair Light is equipped with a light sensor, which is covered with a plastic plug. **Do not cover the sensor plastic plug.**

**INSTALLATION INSTRUCTIONS**

**BEFORE YOU MOUNT YOUR STAIR LIGHT**

Illustration 1

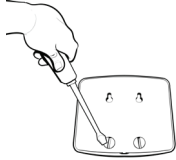

1. Remove rear cover of Stair Light by removing 2 screws on back (Illustration 1).

Illustration 2



2. Set auto shut-off to 20 or 60 seconds as shown in **Illustration 2**. **Setting to 20 seconds will extend battery life.**

Illustration 3



3. Set "GLOW" to 'On' if you want it to glow all night or 'Off' for no glow. Setting to Off will extend battery life.

Illustration 4

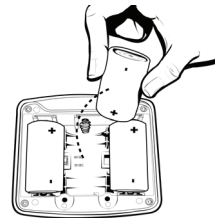

4. Insert 3 C-Cell Batteries into Stair Light as shown in **Illustration 4**. Replace cover. Test by taking it into a dark room.

NOTE: Please use only new alkaline C-Cell batteries with 1.5V rating. Do not mix old and new batteries. Install batteries with polarity in correct position as shown. Stair Light may take up to 30 seconds to activate the first time after batteries are changed. Test in a dark room or closet.

**MOUNTING YOUR STAIR LIGHT**

- **If Mounting Inside, We Recommend Using Double-Sided Tape (Applied as shown in Illustration 8).**
- **If Mounting Outside, Please Follow These Instructions:**

Illustration 5

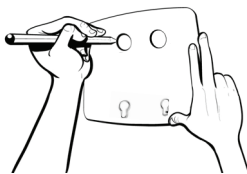

1. Determine location for mounting Stair Light. Flip rear cover upside down and **use holes for thumb screws as template** to mark two holes for anchors and/or screws (included as shown in **Illustration 5**). We recommend mounting the screws parallel to the ground if mounting on a vertical surface. Make sure that screws are precise distance from each other as defined by the distance of the thumbscrew holes. Replace rear cover and insert screws.

Illustration 6



*Screw heads should protrude 1/8" from surface*

2. If using anchors, use 3/16" drill bit to drill holes and insert anchors. Drive screws into anchors so that screw head protrudes 1/8" from the surface (the height of the screw head— **Illustration 6**). If using screws only, use 1/8" drill bit to drill holes and insert screws so that screw head protrudes 1/8" from the surface (the height of the screw head).

Illustration 7

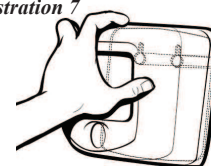

3. Slide Stair Light down so screws are securely held by track (**Illustration 7**).

Illustration 8—Indoor Use Only

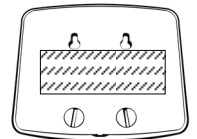

**Please Note: If GLOW is set on "ON" your Stair Light will emit a very low glow once it detects darkness. This low light will continue throughout the darkness. When the Stair Light detects motion it will emit a bright light and will continue on bright until no motion is detected. At that point it will go back into "GLOW" mode.**

**LIMITED WARRANTY**

The product you have purchased is guaranteed against defects in workmanship and materials for the period stated on the package. Warranties implied by law are subject to the same time period limitation. Some states do not allow limitations on how long an implied warranty lasts, so this time limitation may not apply to you. If the product fails due to a manufacturing defect during normal use, return the product and dated sales receipt to the store where purchased for replacement OR send the product and the dated sales receipt to the address above. **Not Covered** – Batteries are not covered by this warranty. Repair service, adjustment and calibration due to misuse, abuse or negligence are not covered by this warranty. Unauthorized service or modification to this product or of any furnished components will void this warranty in its entirety. This warranty does not include reimbursement for inconvenience, installation, set-up time, loss of use, postage, unauthorized service, or other products used in conjunction with, but are not supplied by, Wireless Environment.

**This warranty gives you specific legal rights, and you may also have other rights which vary from state to state.**