

DLED6R12Y

LED retrofit downlights are perfect for updating existing recessed lighting without changing the fixture. Equivalent to 90W Par.

Color: White

Weight: 0.0 lbs

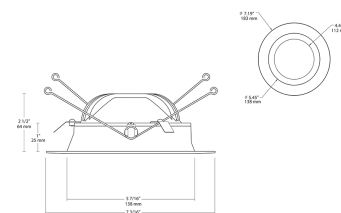

LED Info

Watts: 12W
 Color Temp: 3000K
 Color Accuracy: 86
 L70 Lifespan: 100000
 LM79 Lumens: 764
 Efficacy: 58 LPW

Driver Info

Type: Constant Current
 120V: 0.11A
 208V: N/A
 240V: N/A
 277V: N/A
 Input Watts: 13W
 Efficiency: 91%

Technical Specifications

UL Listed:

Suitable for damp locations.

ENERGY STAR® #174:

This product is ENERGY STAR® qualified.

Compatibility:

Low-profile design for maximum compatibility with many 5" and 6" incandescent recessed downlight housings. See housing compatibility .

Lumen Maintenance:

100,000-hour LED lifespan based on IES LM-80 results and TM-21 calculations.

LEDs:

High-output, long-life LEDs with 3 step binning and integrated driver technology.

Driver:

Innovative integrated driver technology with 120V TRIAC and ELV dimming. See compatibility guide .

Spacing Criteria:

0-180° (along): 1.13.

Lens:

Polycarbonate diffusion lens for smooth light output.

Surge Protection:

2.5kv.

Color Consistency:

3-step MacAdam Ellipse binning to achieve consistent fixture-to-fixture color.

Housing:

Professional-grade, die-cast aluminum construction.

Adapters:

Edison E26 medium base adapter included. GU24 socket adapter sold separately.

Installation:

Pre-installed Torsion springs and optional friction clips are both included to aid in attaching and securing the 6" DLED to the incandescent housing.

Correlated Color Temp. (Nominal CCT):

3000K Warm.

Fixture Efficacy:

58 Lumens per Watt.

Color Accuracy (CRI):

83 CRI.

Equivalency:

12W replaces 90W Par.

Finish:

Chip and fade resistant polyester powder coat finish.

IESNA LM-79 & LM-80 Testing:

RAB LED luminaires have been tested by an independent laboratory in accordance with IESNA LM-79 and LM-80, and have received the Department of Energy "Lighting Facts" label.

California Title 24:

DLED Retrofit Downlight complies with California Title 24 building and electrical codes.

Green Technology:

Mercury and UV free, and RoHS compliant.



DLED6R12Y - continued

Warranty:

RAB warrants that our LED products will be free from defects in materials and workmanship for a period of five (5) years from the date of delivery to the end user, including coverage of light output, color stability, driver performance and fixture finish. See our full warranty .



Tech Help Line: 888 RAB-1000

Email: sales@rabweb.com

On the web at: www.rabweb.com