



Westinghouse

Christmas Light Tester

Test your light set, fuses and individual bulb with ease.

The LIGHT TESTER is a product developed to make the task of finding a bad bulb, wire or socket on your Christmas light string fast and easy. With the push of a button you can locate your light string problem.

Other features included:

- **Bulb Remover** - Allows you to remove bulb from light set.
- **Bulb Tester** - Allows you to test individual bulb.
- **Fuse Tester** - Allows you to test light set fuses.

Sensor

Diagram 1, 2

LED

Push Button

**Two LR44
Watch Batteries
(included)**

Fuse Tester

Diagram 4

Bulb Tester

Diagram 3

**Clip/Battery
Compartment
Cover**

Push down
and pull to open

Bulb Remover

Diagram 5, 6

BATTERY WARNING

Do Not Put in Trash. Recycle or Manage as Hazardous Waste.

 WESTINGHOUSE and INNOVATION YOU CAN BE SURE OF are trademarks of Westinghouse Electric Corporation. Used under license by The NCC. All Rights Reserved.

Distributed by: The NCC, Brooklyn, NY 11220
1.800.730.3707 • www.thencc.com •
© 2013 The NCC

Made in China

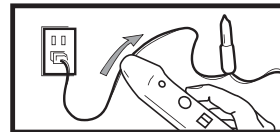

Diagram 1

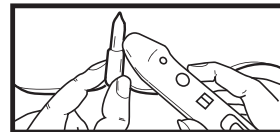

Diagram 2

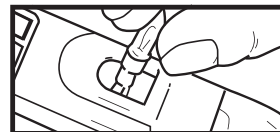

Diagram 3

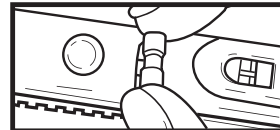

Diagram 4

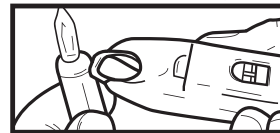

Diagram 5

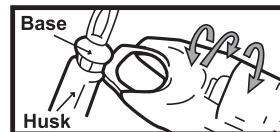

Diagram 6

Item #28540



125VAC/15A/1875W

14



6 86140 28540 0